

Schulgrundstück Fläche 17.200m²

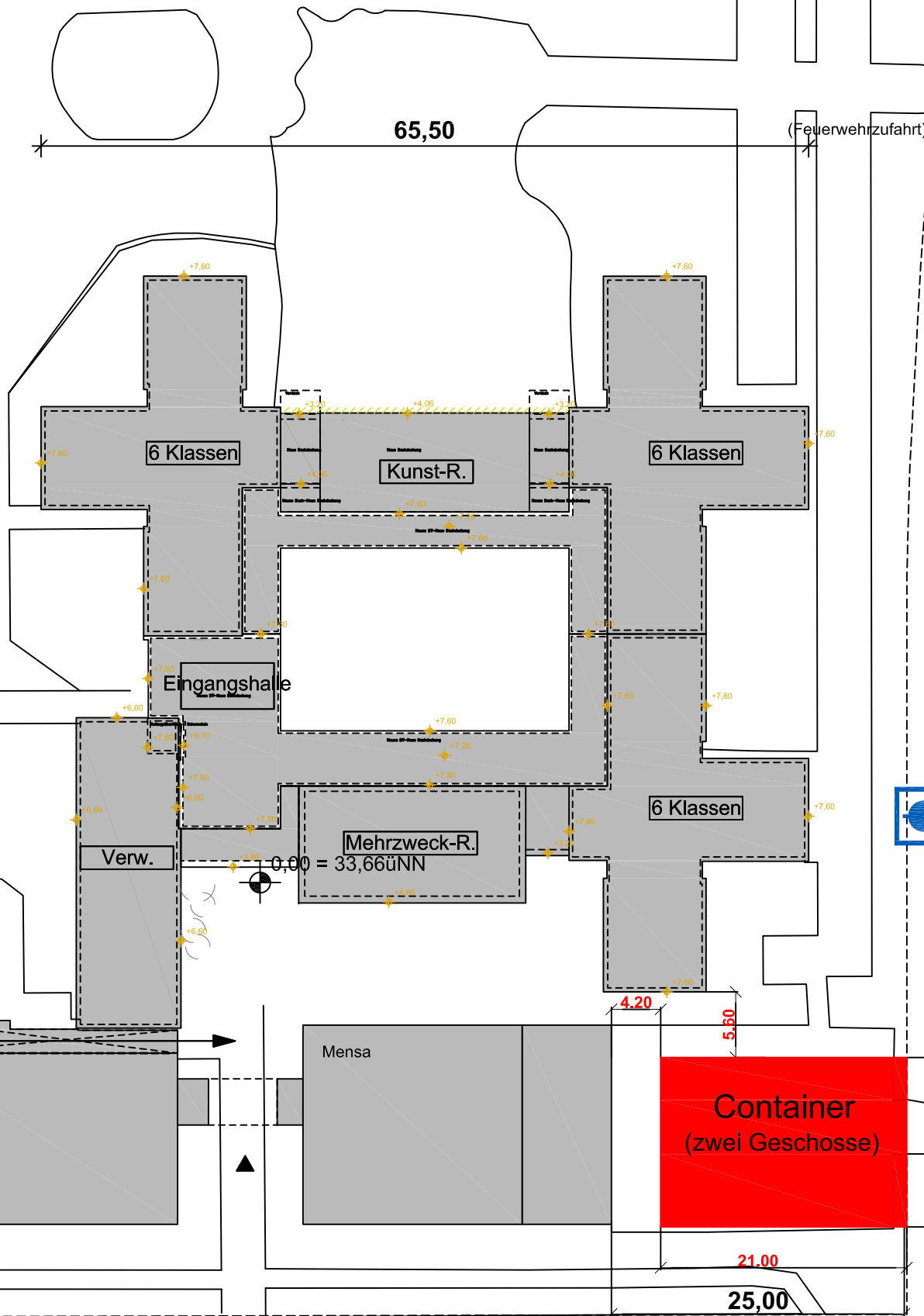

DN 80

Westenwaldstraße

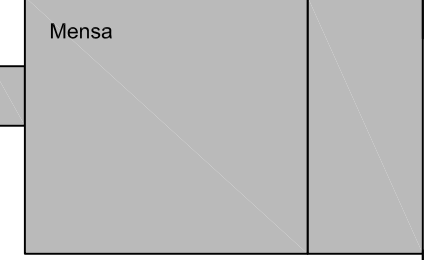
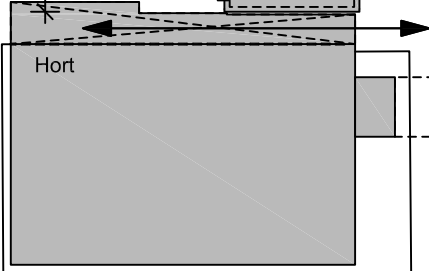
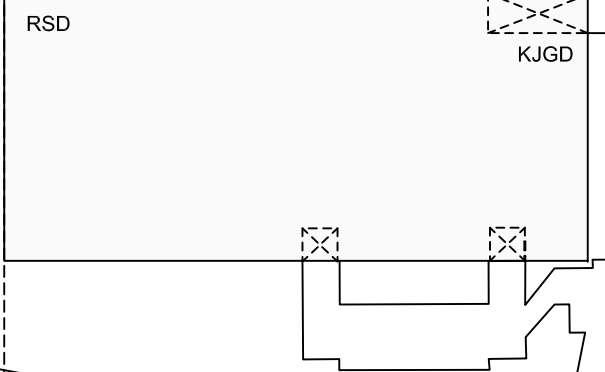
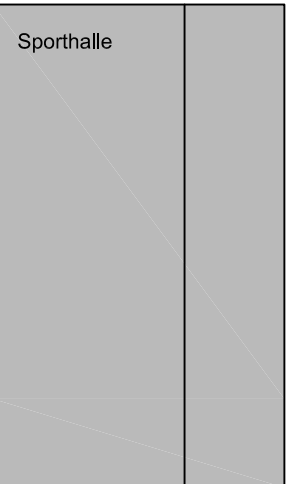
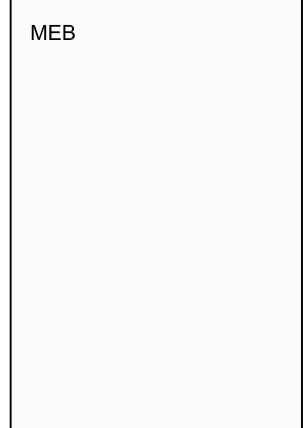

DN 80

Hermann-Schmidt-Weg (Feuerwehrezufahrt)

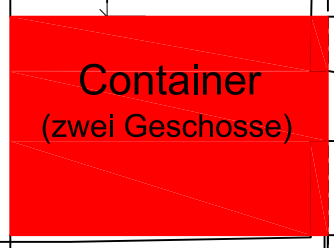

Container
(zwei Geschosse)

21,00

25,00

14,45

4,20

5,60

Sanierung Bestandsgebäude Siegerland-Grundschule / Hermann-Schmid Weg 4, 13589 Berlin-Spandau

Maßstab: 1:500

Datum: 23.12.2016

SEFM Hoch I 1

CONTAINER mit zwei Geschossen

Container

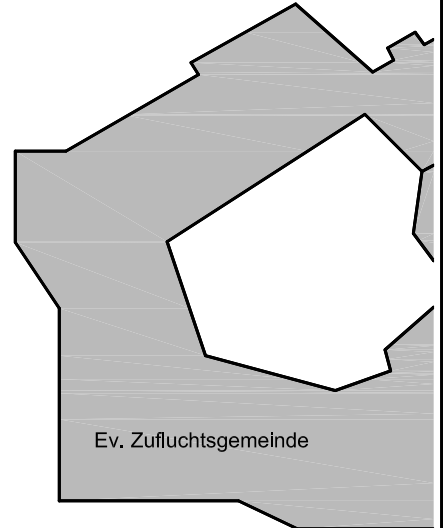

Ev. Zufluchtsgemeinde

ehe